



Polarization Insensitive Isolator (High Reliability)

Key Features

- High Reliability

Applications

- Submarine Optical Fiber Communication

Specifications

| Parameter | Unit | Dual Stage |
|---|------|------------------------|
| Center Wavelength (λ_c) | nm | 1550 |
| Min. Isolation, 1524/1550/1573 nm, 0/23/45 °C, All Polarization States | dB | 38 |
| Max. Insertion Loss, 1524/1550/1573 nm, 0/23/45 °C, All Polarization States | dB | 0.4 |
| Min. Return Loss, 1524/1550/1573 nm, 23 °C | dB | 55/55 |
| Max. Temperature Dependent Loss, 1524/1550/1573 nm, 0/23/45 °C | dB | 0.12 |
| Max. Polarization Dependent Loss, 1524/1550/1573 nm, 0/23/45 °C | dB | 0.1 |
| Max. Wavelength Dependent Loss | dB | 0.15 |
| Max. Polarization Mode Dispersion | ps | 0.05 |
| Max. Optical Power (Continuous Wave) | W | 2 |
| Max. Reverse Power Handling | mW | 300 |
| Max. Tensile Load | N | 5 |
| Fiber Type | | SMF-28e+Fiber 200 Kpsi |
| Operating Temperature | °C | 0 to + 45 |
| Storage Temperature | °C | - 40 to + 85 |

*IL is 0.3 dB higher, RL is 5 dB lower for each connector added.

Package Dimensions

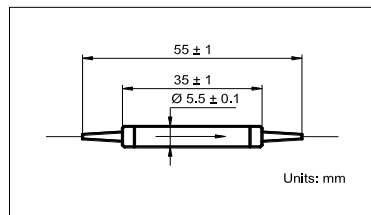

Ordering Information

Dual Stage: PDSI-①①-②-③-④-⑤-⑥-SUB

| | | | |
|--|---|-----------------------------------|--|
| ①①: Wavelength 55 - 1550 nm SS - Specify | ②: Grade P - Premium | ③: PMD 2 - Refer to Above Spec | ④: Connector Type 1 - FC/UPC 4 - SC/APC 2 - FC/APC N - None 3 - SC/UPC S - Specify |
| ⑤: Fiber Type B - 250 μ m Bare Fiber L - 900 μ m Loose Tube S - Specify | ⑥: Fiber Length 1 - 1.0 m S - Specify | | |